

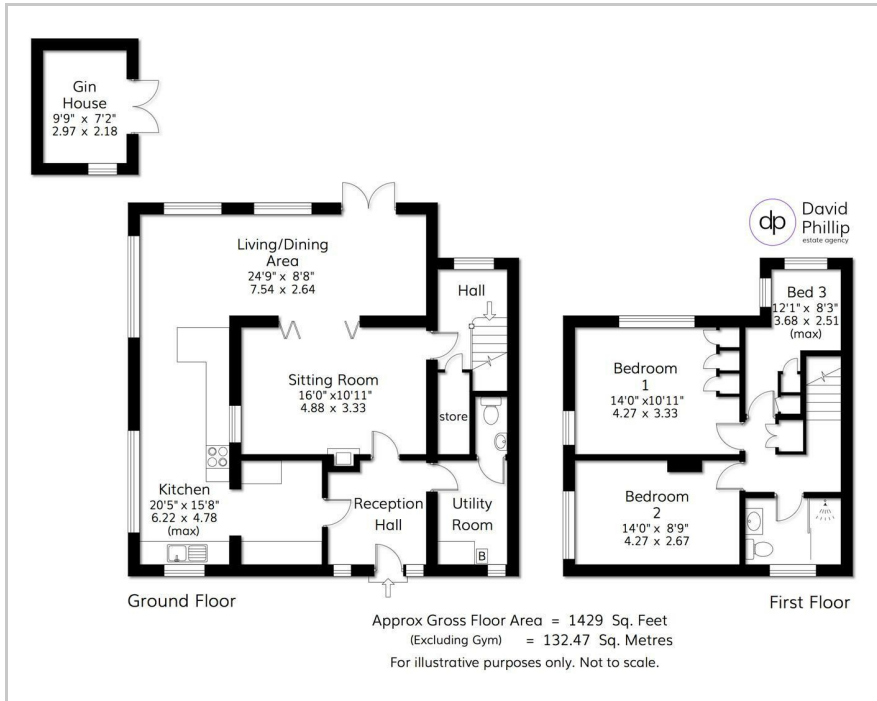

1 Milestone Cottages Leathley Lane, Otley, LS21 2JX

Price Guide £550,000

Floor Plan



Area Map



Accommodation

- Stunning Extended Stone Built Semi-Detached House
- Three Good Sized Bedrooms and Luxury Bathroom
- Flexible and Spacious Ground Floor Layout
- Generous Level Lawn and Private South Facing Patio
- Idyllic Lower Washburn Village Setting with Views Over Adjoining Natural Fields
- Garage and Large Parking Space for Several Cars
- Energy Performance Certificate Rating E / Local Authority Harrogate Council Tax Band E
- OFFERED WITH NO ONWARD CHAIN

Viewing

Please contact our David Phillip Estate Agents Office on 01134 676 400 if you wish to arrange a viewing appointment for this property or require further information.

Energy Efficiency Graph

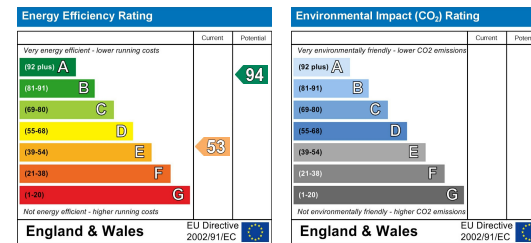

These particulars, whilst believed to be accurate are set out as a general outline only for guidance and do not constitute any part of an offer or contract. Intending purchasers should not rely on them as statements of representation of fact, but must satisfy themselves by inspection or otherwise as to their accuracy. No person in this firm's employment has the authority to make or give any representation or warranty in respect of the property.